

# SERVICE BULLETIN

## 3" Pump Changes

Model Series Affected: LM2350E-X

RELEASED: 10-28-98  
REVISED: 1-10-12  
REV: 00  
BULLETIN: #6-98  
FORM: 4303-2

Changes affect models built prior to "-B" models. (Oct. '98)

**NEW PUMP BASE DESIGN** - A new design eliminates the lower cap part. This part is now incorporated into the new base design. Parts indicated by (\*) are all required to update to the new design.

The following changes were made to make the "-B" model.

- 1) Parts eliminated: Lower Cap 94391 (Incorporated into new Base), Bushing 94374, O-ring Y325-219.  
NOTE: 637227-B Service Kit is used for repair all models. This kit includes a ☆Y325-219 O-ring which is not used on LM2350-X-B models.
- 2) Parts added: Spring 94705, Washer 94785.
- 3) Part change: Pin 90274 (.890) to Pin 94786 (.781), the new shorter pin is required to fit inside the new spring.
- 4) The Rod Seal 93921 moved to the bottom side of the Base.

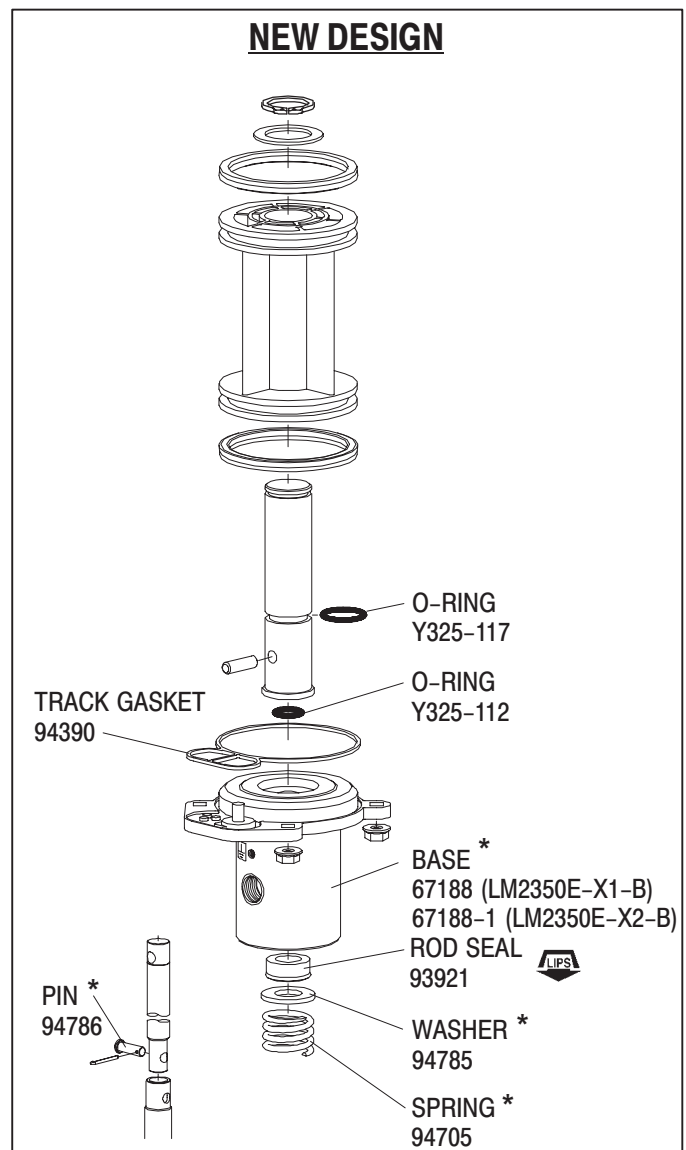
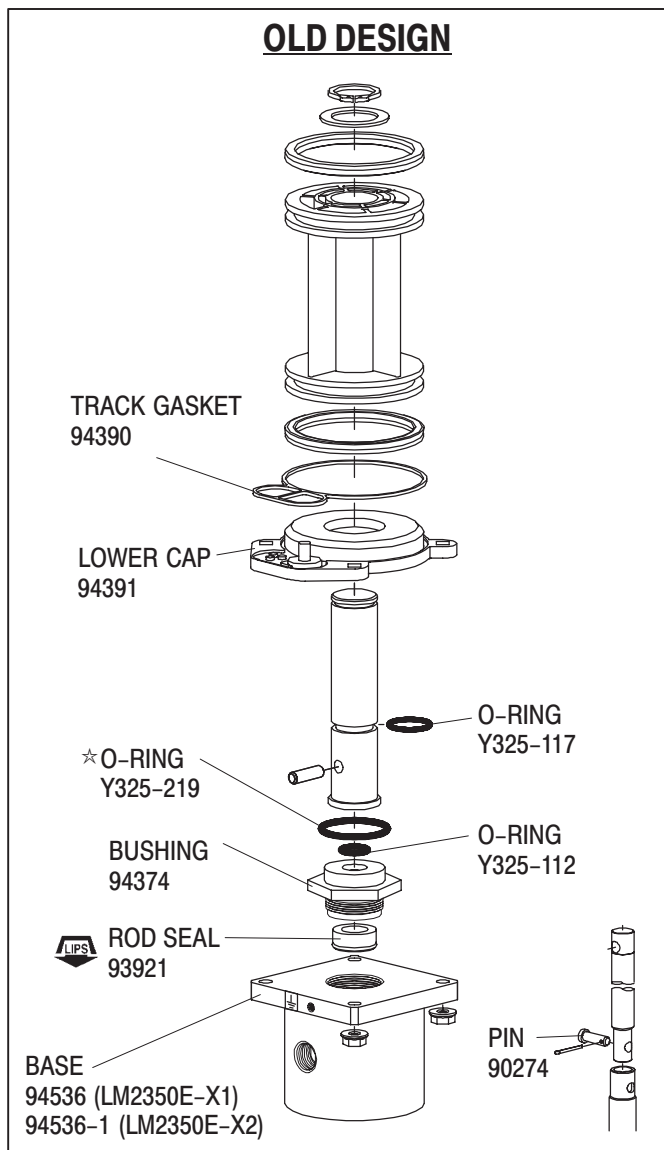

PN 97999-1595

**INGERSOLL RAND COMPANY LTD**

209 NORTH MAIN STREET - BRYAN, OHIO 43506

☎ (800) 495-0276 • FAX (800) 892-6276

© 2012 CCN 46735023

www.ingersollrandproducts.com

# ARO

**IR** Ingersoll Rand  
Industrial Technologies